

Temprare solo la superficie eccentrica

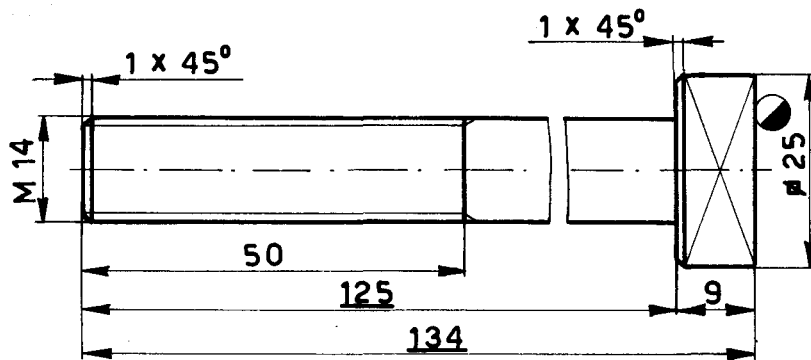

3

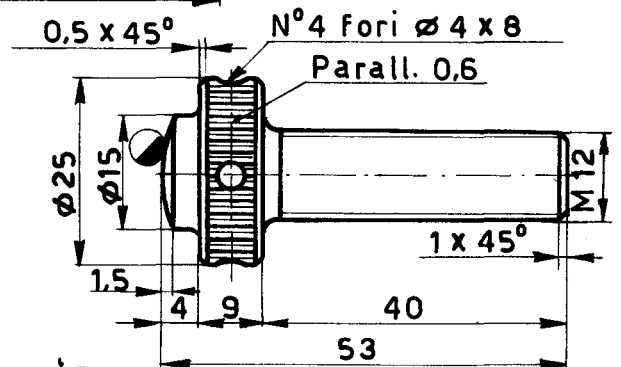

10

Cem. e temp. l'estr. sferica

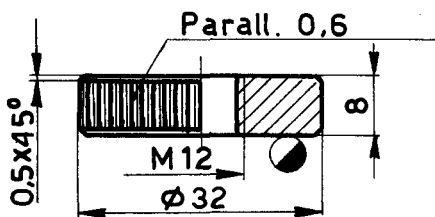

11

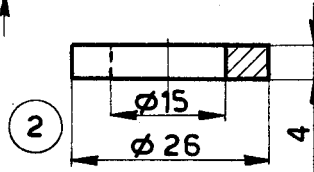

2

POS.	DENOMINAZIONE	QUANT.	DIMENS. GREZZO	MATERIALE	NOTE
11	DADO ZIGRINATO	1	ø 33 x 13	12 NC 3	Bonif.
10	PUNTALINO	1	ø 26 x 58	C 10	Cem. e temp. l'est.
8	LEVA AD ECCENTRICO	1	ø 25 x 119	C 10	Cem. e temp. l'est.
3	VITE A TESTA QUADRA	1	ø 36 x 140	C 21	
2	RONDELLA	1	ø 28 x 8	C 30	Bonif.

TOLLERANZE

TEMPO CONCESSO

SCALA 1:1



ESERCIZIO  
PROPOSTO DA